



KÄRNTEN
University of
Applied Sciences

pro:Holz

005

transformBAR24

wiederverwenden
wiederverwerten
umnutzen

DER BESTAND

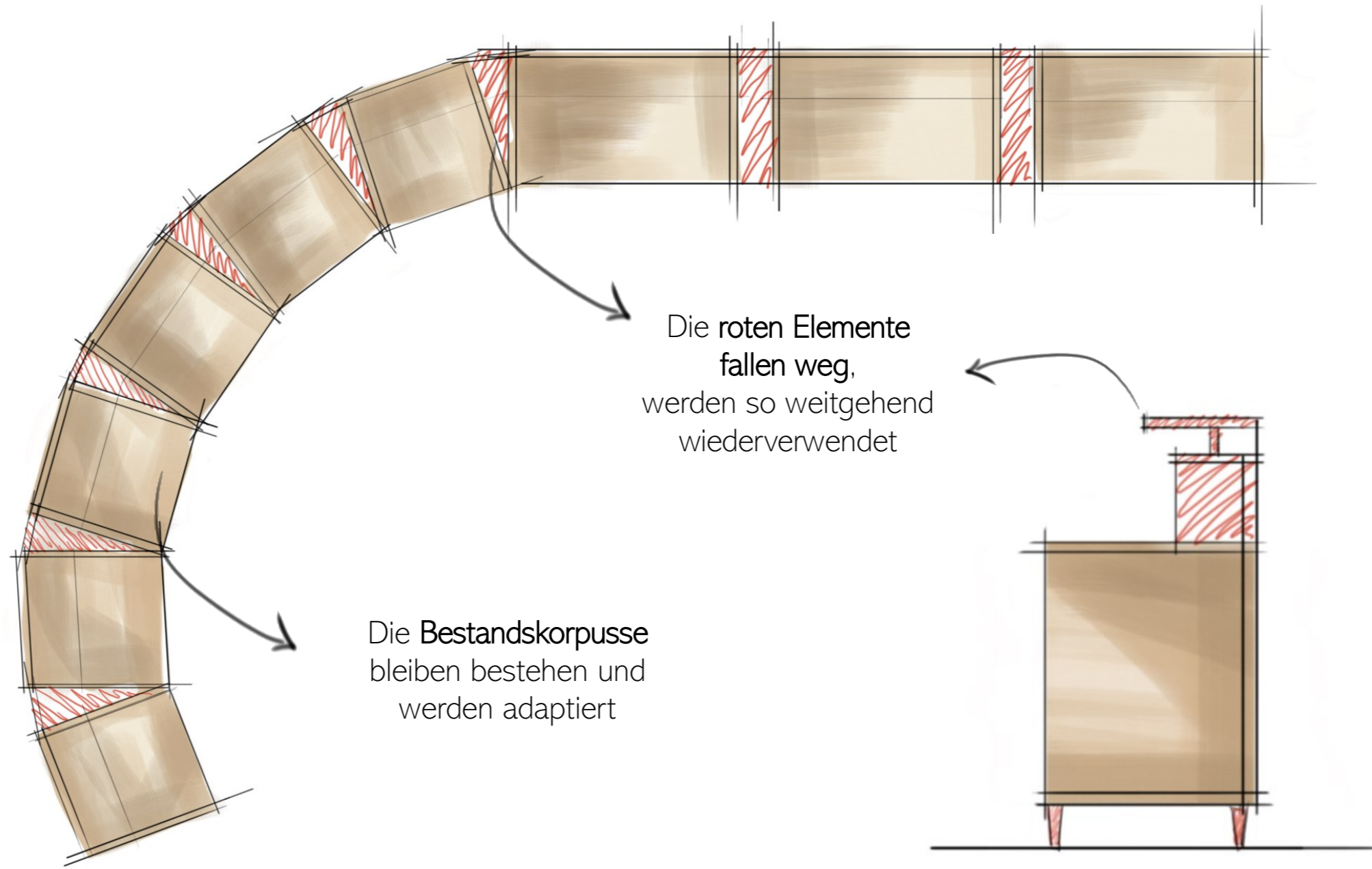

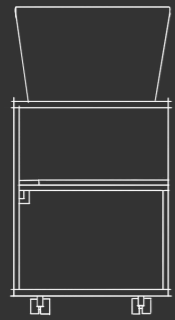

BAR

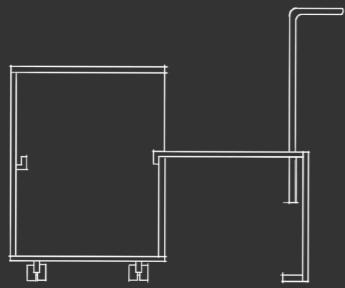

STUDY

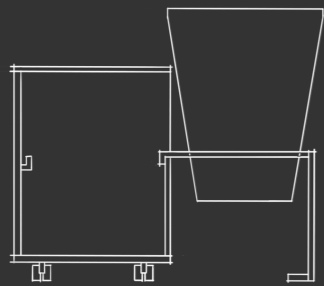

CHILL

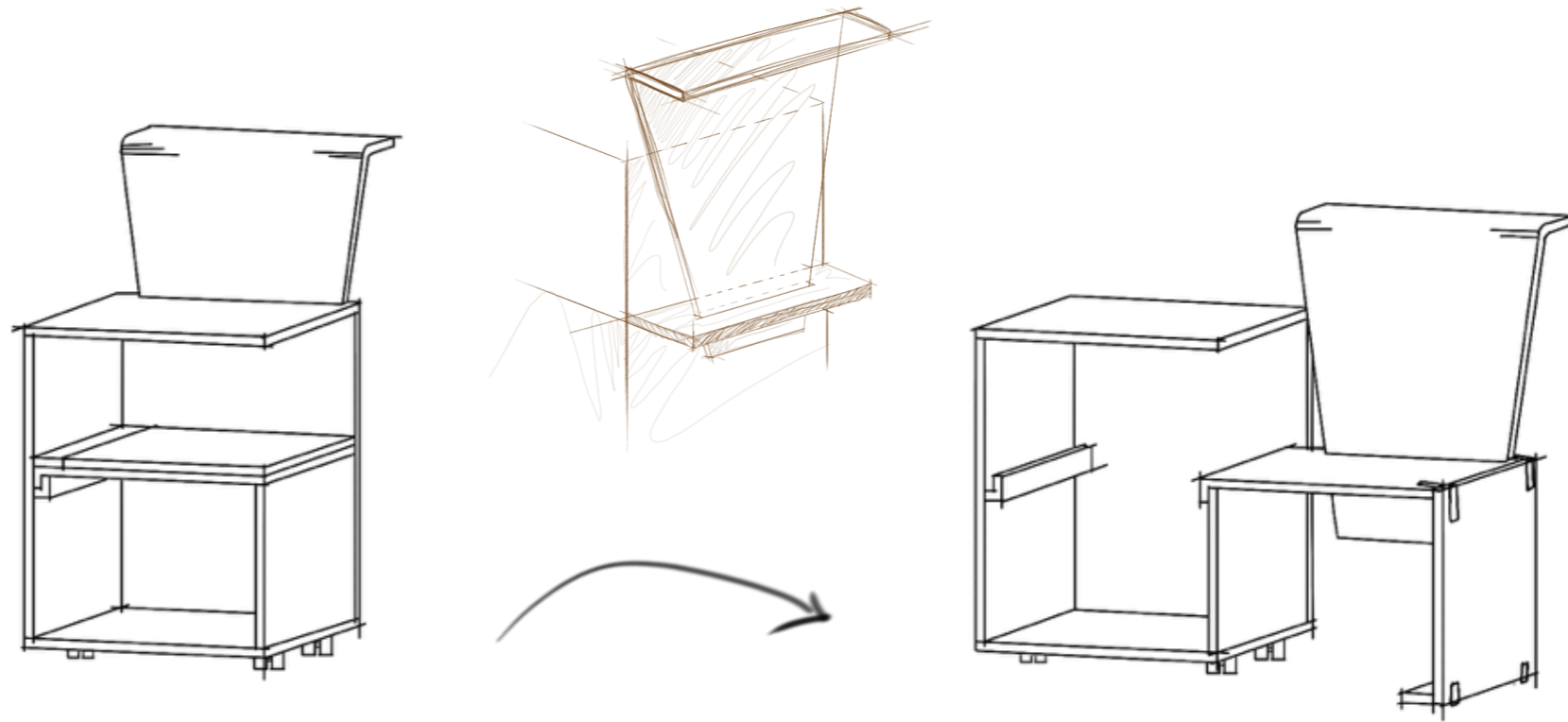

DIE TRANSFORMATION

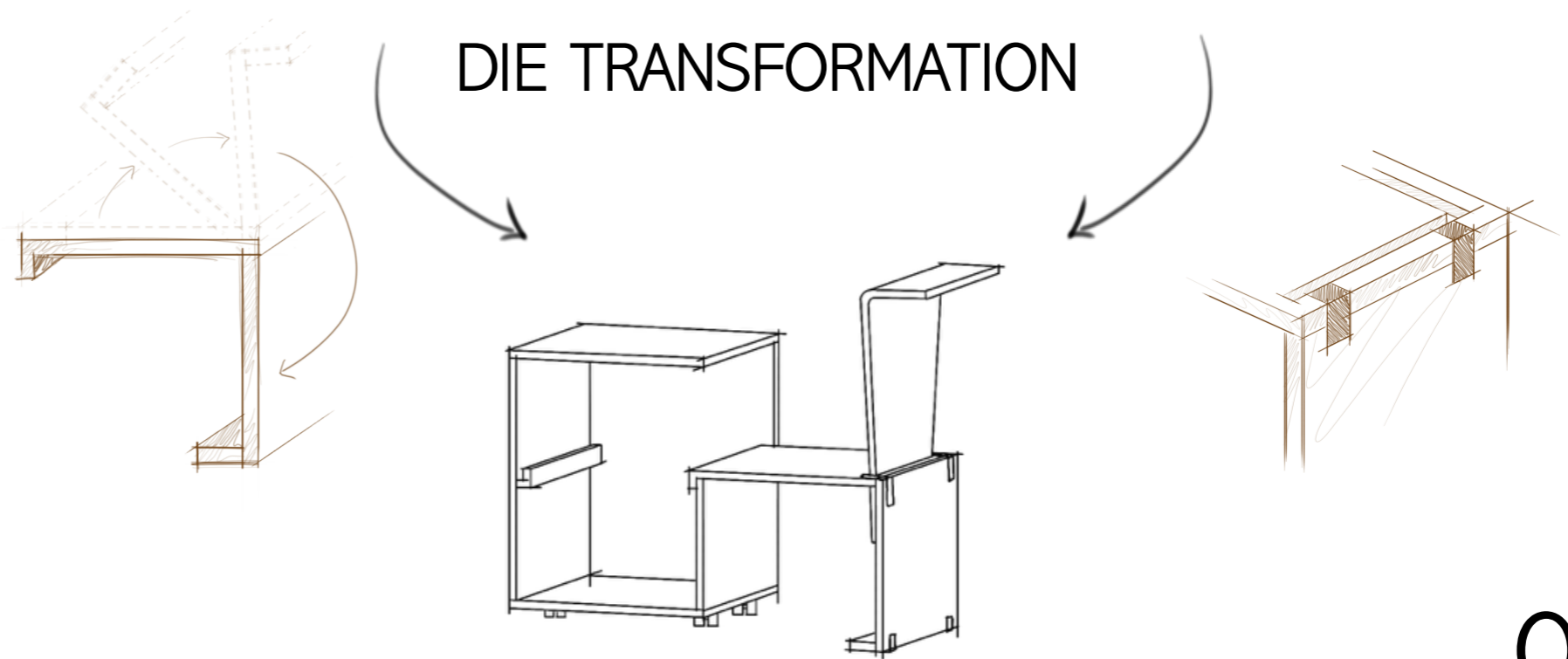

DER KLEINE KORPUS

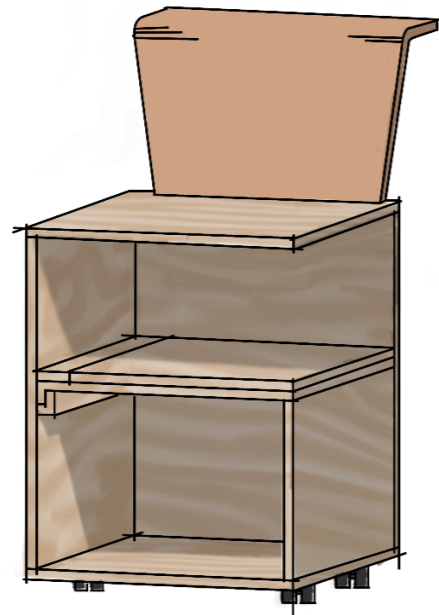

Variante A
BAR

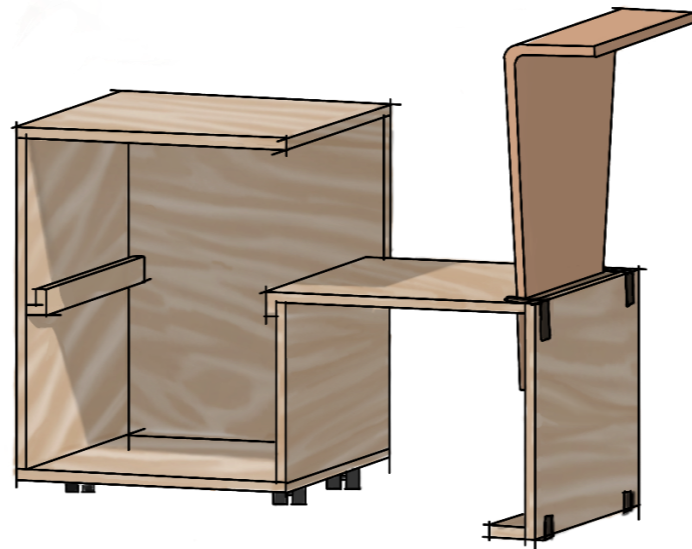

Variante B
STUDY

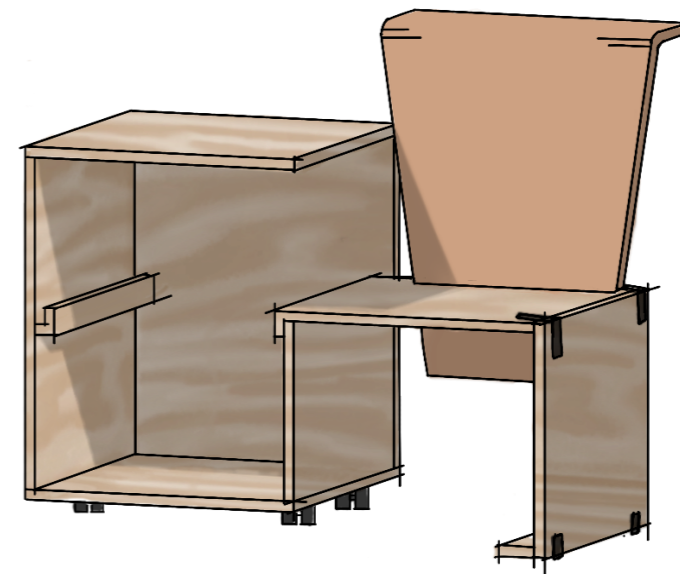

Variante C
CHILL

DER GROSSE KORPUS

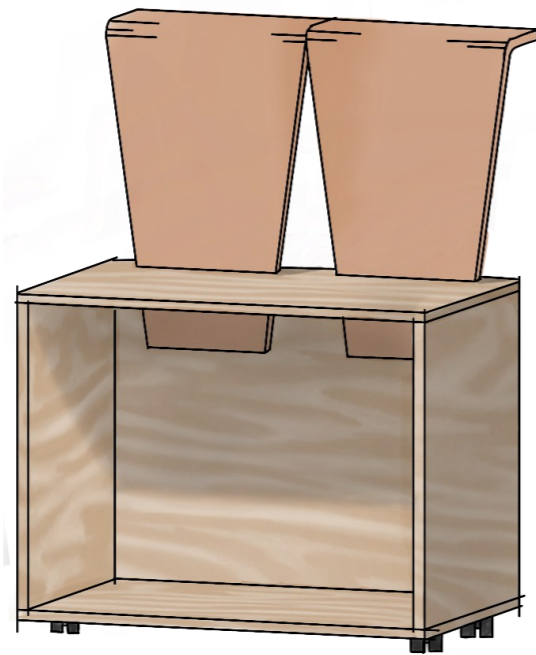

Variante A
PRESENTATION

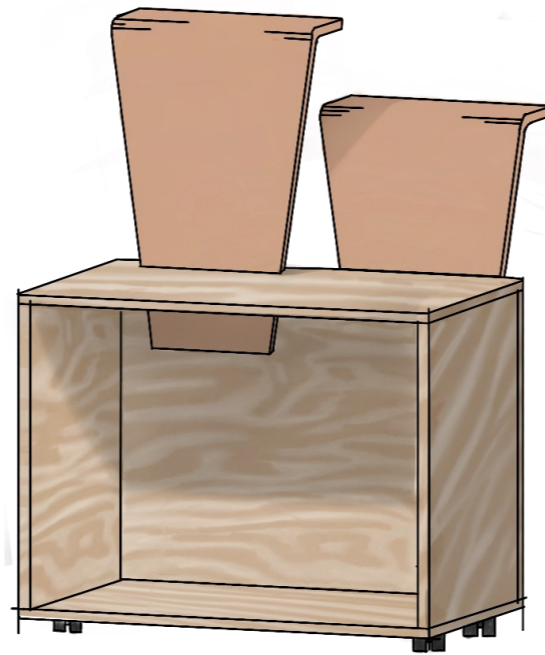

Variante B
PRESENTATION

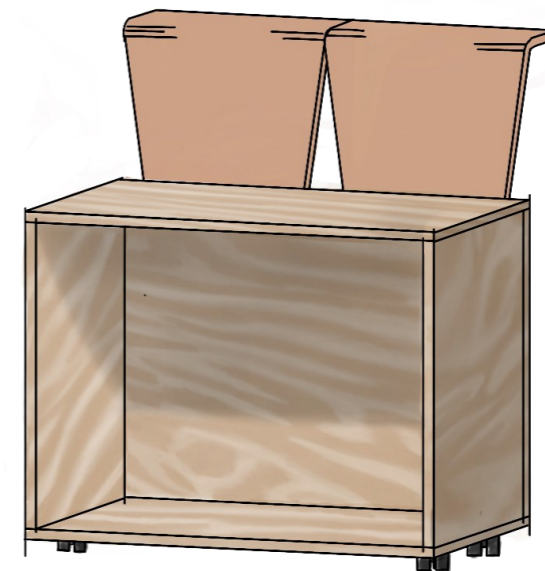

Variante C
BAR

DIE IDEE

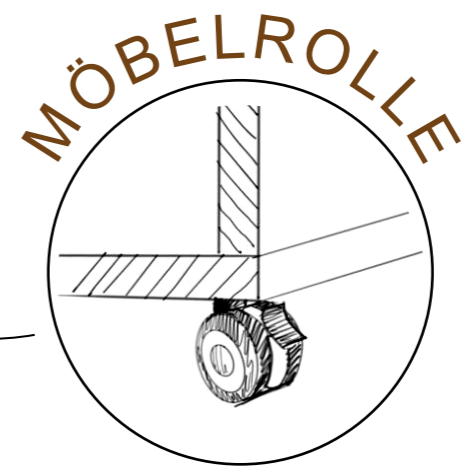
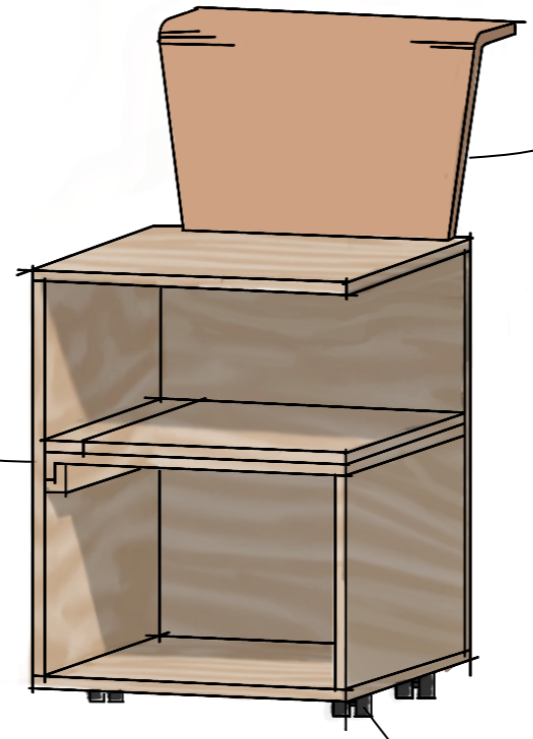
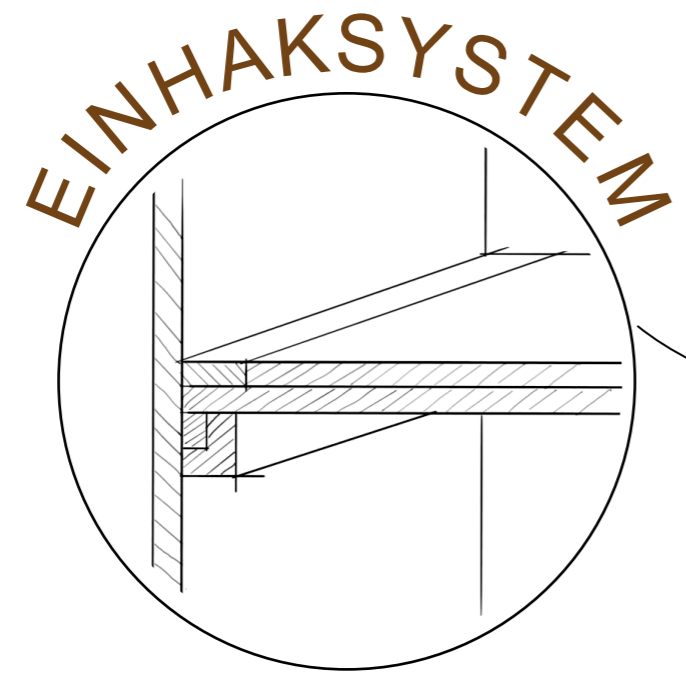

DIE GRUNDRISSE & ANSICHTEN

Variante A

BAR

GR

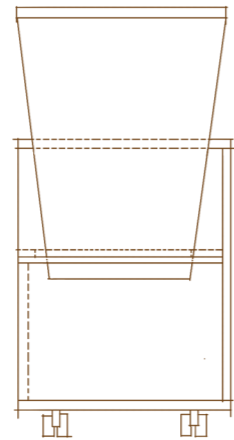
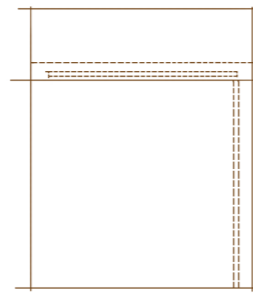

ANSICHT

Variante B

STUDY

GR

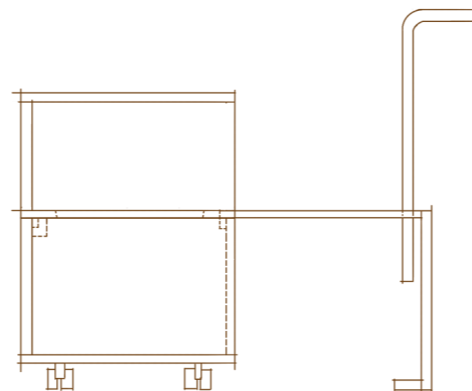
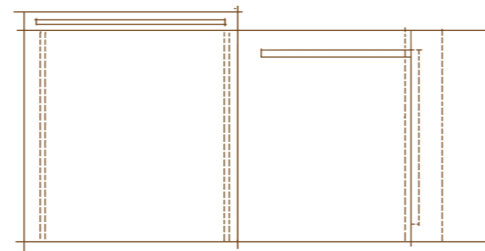

ANSICHT

Variante C

CHILL

GR

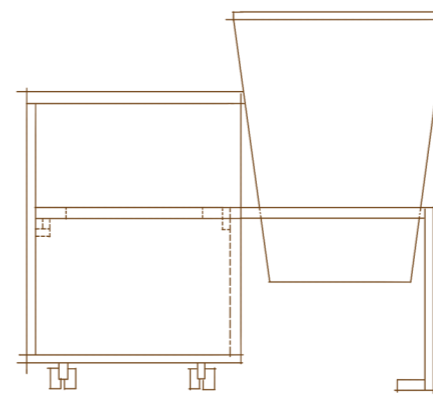
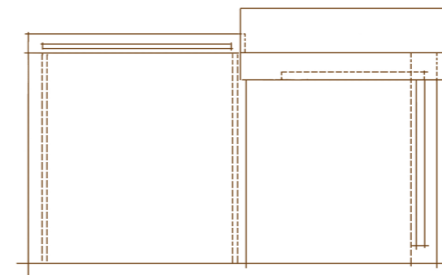

ANSICHT

DIE GRUNDRISSVARIANTEN

Die einfache Form der umgestalteten Thekenelemente macht unzählige Grundrissvarianten möglich.

Beispielsweise könnten die Elemente somit eine Präsentationsfläche, einen Co-Working Space oder auch eine Bar bilden. Die rollbaren Elemente können leicht und schnell umgestellt werden.

PRÄSENTATIONSFLÄCHE

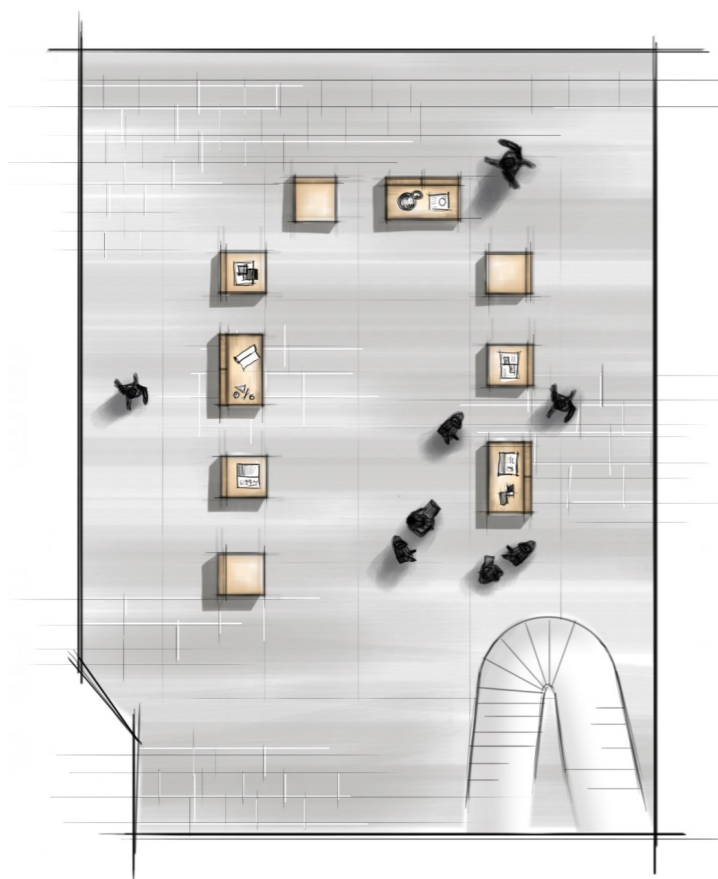

CO-WORKING SPACE

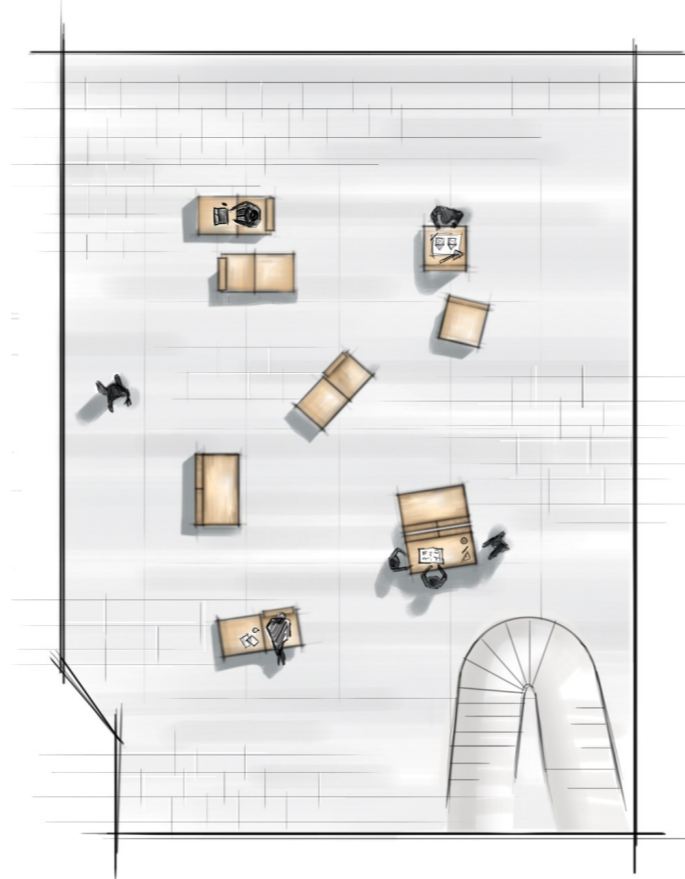

BAR

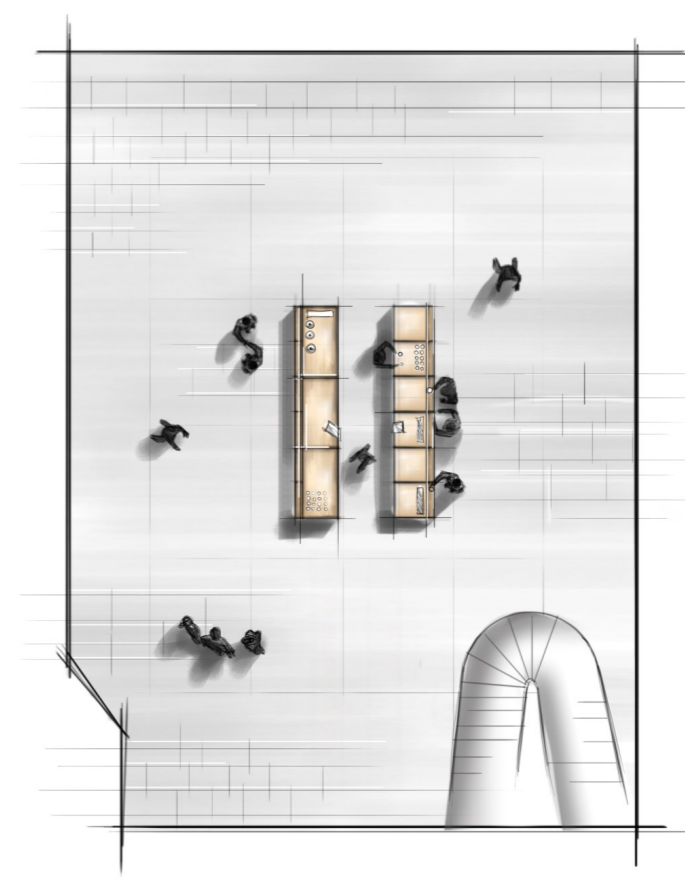

DAS MODELL M 1:10

Variante B

STUDY



Variante C

CHILL



Variante A

BAR

